

# Installation Guide

## Steering wheel control Interface

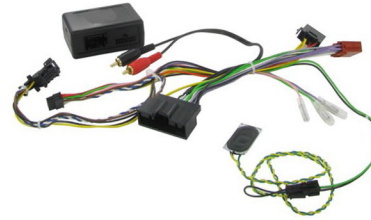

CA-R-FOR.005  
Ford Interface

1 Remove Original Head Unit

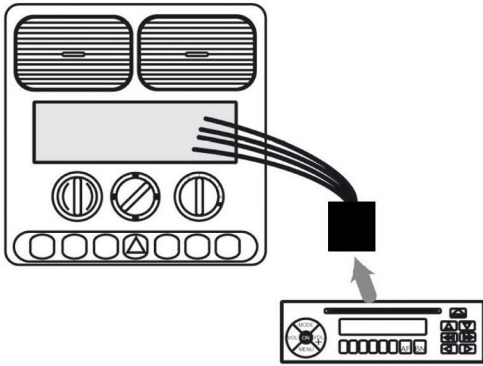

2

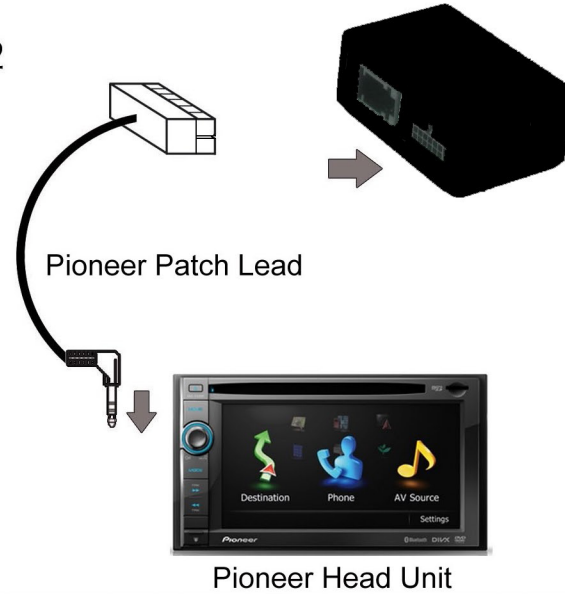

3

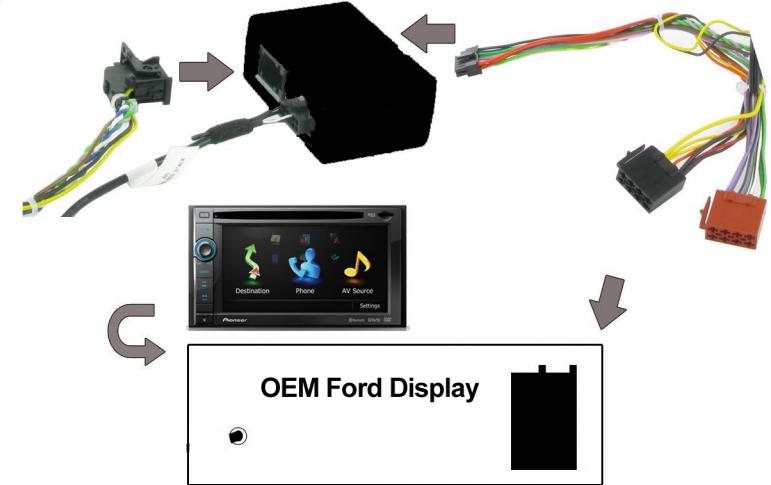

4

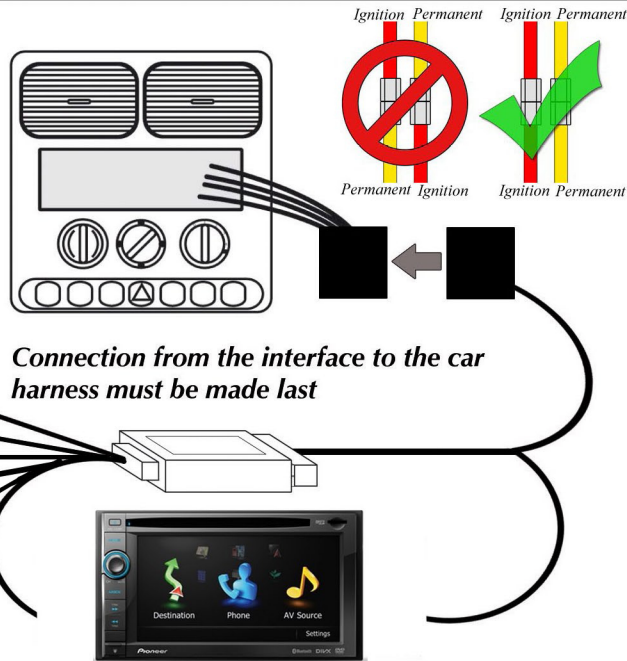

5

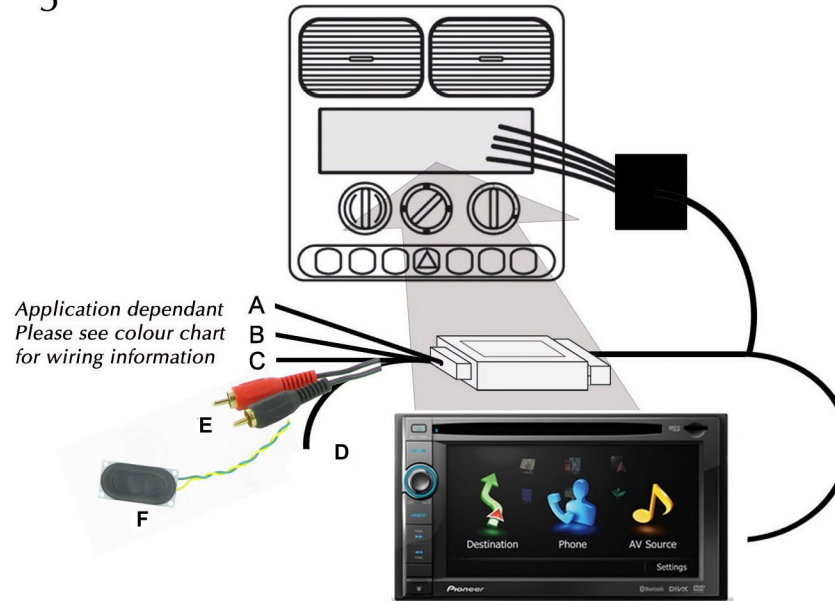

6

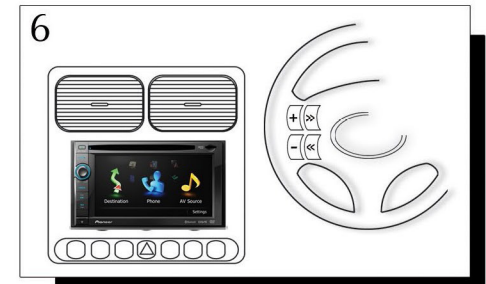

- |                       |   |
|-----------------------|---|
| A - Pink Wire         | = Speed Pulse   |
| B - Green Wire        | = Park Brake  |
| C - Purple/White Wire | = Reverse   |
| D - Blue/White Wire   | = Antenna Remote  |
| E - RCA Leads         | = Connect to<br>Aftermarket head unit AUX in, to retain<br>factory AUX Plug |
| F - Speaker           | = Connect to slot<br>on the rear of facia plate                             |

Pioneer

# Installation Guide

Part No: CA-R-FOR.005 Ford Can-Bus Steering Wheel Control Interface

Pioneer

## User guide to change the time and date



- 1 - Speech Button
- 2 - Select Right
- 3 - Select up
- 4 - Select left
- 5 - Select down

Single Press (**Button 1**) switches display on .  
Press & Hold **Speech Button (button 1)** for 2 seconds this will enable menu mode option.

Press (**Buttons 3/5**) **Up/down** till clock setting is selected.  
Then press (**Button 1**) to confirm.

To Adjust the clock use (**Buttons 3/5**),select the next option use (**Buttons 2/4**).and then press (**Button 1**) to confirm.

Press (**Buttons 3/5**) **Up/down** till set date is selected  
Then press (**Button 1**), to confirm.

To adjust the date use (**Buttons 3/5**) And to select the next option use (**Buttons 2/4**) .press (**Button 1**) to confirm.

When the time and date has been set,  
Press the **speech button(Button 1)** once to confirm.

**The menu option will time out after 15-20 seconds.**

